

**Roll-In Blast Chiller / Shock Freezer**  
**MultiFresh Model MF 130.2**

**MF 130.2**

**... YOUR TRUSTED KITCHEN ASSISTANT**

The **IRINOX Model MF 130.2 Blast Chiller / Shock Freezer** shall have the following characteristics: Capacity – one (1) single universal-angle roll-in rack: up to (24) 12"x20"x2-1/2" steam table pans or up to (12) 18"x26" full size sheet pans; controller - shall feature the following control paths: standard mode for chilling or freezing, dynamic mode for chilling or freezing (icon driven) and personalized modes for chilling or freezing customer specific products; core probe – multi-sensor product core temperature probe with five (5) measuring points and "easy-out" feature; plus all the standard features listed below.



Model MF 130.2

Item No. \_\_\_\_\_  
 Qty. \_\_\_\_\_  
 Project \_\_\_\_\_  
 \_\_\_\_\_  
 \_\_\_\_\_  
 \_\_\_\_\_

**Standard Construction Features:**

- All type 304 stainless steel construction
- CFC-free high-density polyurethane insulation
- Full width door with low-temperature resistant magnetic gasket
- Die-stamped interior door liner to magnetically store core probe
- Ergonomic edge-free stainless steel door handle
- Integrated single compressor and condenser
- Approved R404 refrigerant used in sealed system
- High efficiency evaporators with multiple injection points
- Luminous display with intuitive work-path controls
- USB port for data transfer to HACCP software, internal software upgrades and individual program uploads
- Door hinged right (standard)
- End-of-cycle hold mode
- Energy-efficient, air-cooled, remote condenser

**Sizing & Unit Production Guide MF 130.2**

Capacity: (12"x20"x2-1/2") steam table pans	24
Capacity: (18"x26") full size sheet pans	12
Roll-In rack, Universal-Angle	1
Blast Chilling Capacity (194F to 37F)*:	300 lbs.
Shock Freezing Capacity (194F to 0F)*:	300 lbs.

\* Per production cycle (depending on product density):  
 Blast chilling ... up to 90-minute cycle  
 Shock freezing ... up to 240-minute cycle

**Unique Design and Performance Features:**

- 4 cycles in standard mode, 39 product specific cycles in dynamic mode; ability to record up 20 replicable cycles into customized recipe book
- 30-40% more energy efficient, with faster chilling times - all while preserving the freshness and fragrance of the food
- Electronically controlled fans with low power consumption; fans stop automatically when door is open
- Indirect air distribution and special airflow pattern to ensure perfect temperature uniformity
- Moisture preservation system by "delta-t" control
- Smudge-resistant controller touch pad
- Easy access to washable evaporators and waterproof fans

**Options and Accessories (Please check):**

- Sous-vide pouch core temperature probe
- Prison package
- Door hinged left
- Rolling rack: (24) 12"x20"x2-1/2" steam table pans or (12) 18"x26" full size sheet pans
- SANIGEN sanitation system
- Water-cooled, remote condenser
- Portable HACCP data printer
- HACCP software
- Additional food temperature core probe (up to 2)
- 5 year compressor warranty

**Product Warranty Protection:**  
 - 1 year, parts and labor



# MF 130.2

**...YOUR TRUSTED KITCHEN ASSISTANT**

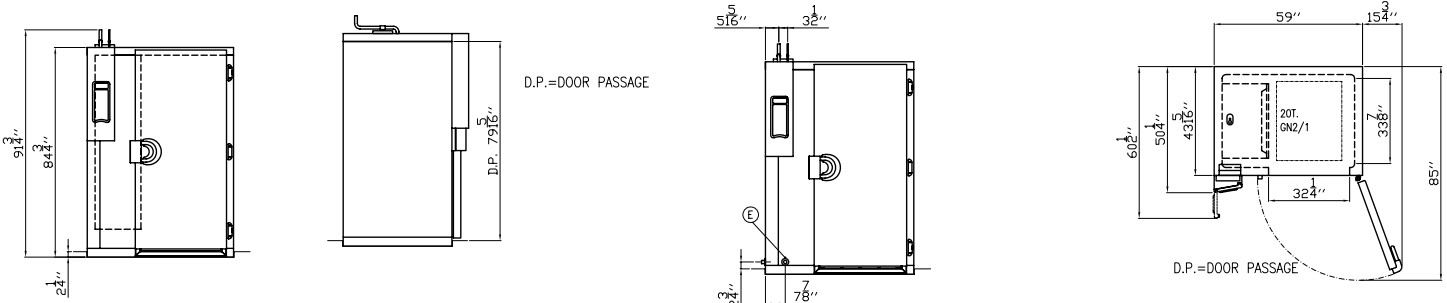

<b>Cabinet Dimensions and Weight</b>	<b>Sunken Floor</b>	<b>External Ramp</b>
Width	59"	59"
Depth	50-1/4"	68"
Height	82-3/4"	85"
Weight (unit)	980 lbs.	980 lbs
Weight (crated)	1140 lbs.	1140 lbs
<b>Cabinet Electric Data / Power Requirements</b>		
208V 60 Hz 3 Phase		2.1 HP
208V 60 Hz 3 Phase		5.2 A

**[D] Drain Connection:** 1-1/2" ID [Per local codes]

**Installation Notes:**

1. Installation and charging of refrigeration lines are the responsibility of owner or installation contractor.
2. 5 wires # 14AWG must be installed by owner or installation contractor between the chiller and the condenser unit. The connection should be performed according to the electrical diagram.
3. If installed outdoors, condenser unit should be protected from direct sunlight and provided with a minimum of 40" air space
4. If installed over 75' from chiller, installer must contact IRINOX USA for proper refrigerant pipe sizing

Continued product development may necessitate specification changes without notice.

Rev. 12/10



# MF 130.2

**...YOUR TRUSTED KITCHEN ASSISTANT**

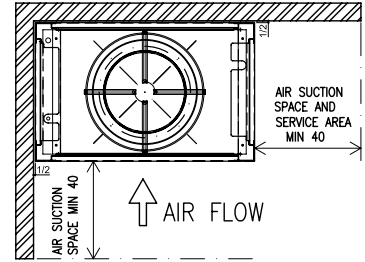
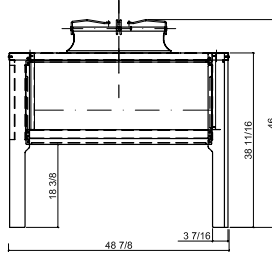
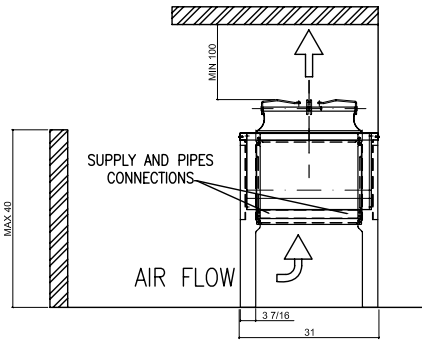

<b>Remote Condenser, Air - Dimensions and Weight</b>		
<b>Condenser: For Chiller</b>	<b>Unit 605 A</b>	<b>Crated 605 A</b>
Width	48-3/4"	60-1/4"
Depth	30-3/4"	34-1/4"
Height	54-3/4"	66-7/8"
Weight	595 lbs	695 lbs
<b>Condenser Unit Electric Data / Requirements</b>		
<b>Model</b>	<b>605 A</b>	
Voltage / Phase / Hz	208/3/60	
Total KW	9.7	
Total HP	13.0	
Amps	33.0	
<b>Key Refrigeration System Data</b>		
Compressor rating (HP)	6	
Refrigeration Yield (14/+104F) (BTU/HR)*	49,965	
Remote Condenser	Standard	
Refrigerant Type	R404A	
Discharge Connection	1/2"	
Suction Connection	1-1/8"	
Start Current (Locked Rotor)	71 A	
Displacement	968 cu.ft /hour	

\* Sized to a 14 F suction line, 104 F liquid line

Continued product development may necessitate specification changes without notice.



Rev. 12/10



IRINOX USA 31 Eastman Street, South Easton, MA 02375  
 Phone: 508-230-5818 Fax: 508-230-5819 www.irinoxusa.com email: info@irinoxusa.com



*IRINOX USA 31 Eastman Street, South Easton, MA 02375*  
*Phone: 508-230-5818 Fax: 508-230-5819 [www.irinoxusa.com](http://www.irinoxusa.com) email: [info@irinoxusa.com](mailto:info@irinoxusa.com)*